

N-TYPE ROTARY TORQUE TRANSDUCER

DESCRIPTION

The AWS LTD N-type Rotary Torque Transducer range (NRTT), is designed to accurately measure torque values in a rotating shaft, in a variety of industries. With optimised torque ranges, the transducer outputs a mV signal proportional to the supply voltage and torque. The transducer contains a memory chip in which a small selection of parameters, including serial number, model number, and calibration value, are held, compatible for setting some manufacturers display units. The NRTT can be produced with different adapters depending on its use including square (standard) and keyway (option).

SPECIFICATIONS

Model: NRTT-	3041	3042	3043	3044	3045
Ranges:	0.4-10Nm	2-50Nm	10-250Nm	20-500Nm	40-1000Nm
Square Drive Size:	1/4"	3/8"	1/2"	3/4"	3/4"
Keyway Size:	Multiple sizes	Multiple sizes	Multiple sizes	Multiple sizes	Multiple sizes

Accuracy:	Better than 0.1% of reading from 10 to 100% of rated output. See calibration certificate for full results.
Signal Output:	2mV/V
Communications:	Not Applicable
Bridge Impedance:	350Ω
Max Voltage and Current Requirement:	10V DC 30mA
Power and Display:	Requires DC power supply and Dedicated mV meter
Adapter:	The NRTT can be produced with shaft ends suitable to its indented function.
Speed:	Standard 20,000 RPM
Overload capability:	125%
Maximum mechanical overload:	160% of range stated.
Operating Temperature:	-10°C to +50°C.
Connector:	Mil C 26482 series. 6 pin. Shell size 10.
CE:	2014/30/EU
EMC:	BS EN 61326:2007

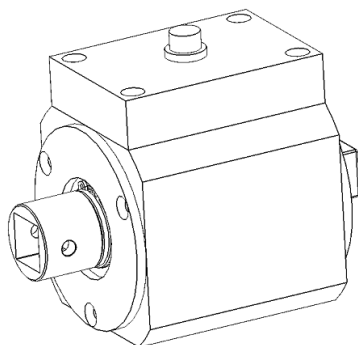

Advanced Witness Systems Ltd © 2024

MANUFACTURER INFORMATION

Advanced Witness Systems Ltd
Unit 8
Beaumont Business Centre
Beaumont Close
Banbury
OX16 1TN
Tel: +44 (0)1295 266939
Email: sales@awstorque.co.uk

SUPPLIER INFORMATION