

# ANALOGUE ROTARY TORQUE TRANSDUCER

## DESCRIPTION

The AWS LTD Analogue Rotary Torque Transducer range (ARTT), is designed to accurately measure torque values in a rotating shaft, in a variety of industries. With optimised torque ranges, the transducer uses a standard analogue connection through a male MIL C connector, from a full active Wheatstone bridge, outputting a mV reading. The ARTT can be produced with different adapters depending on its use including square (standard) and keyway (option).

## SPECIFICATIONS

Model: ARTT-	2041	2042	2043	2044	2045
Ranges:	0.4-10Nm	2-50Nm	10-250Nm	20-500Nm	40-1000Nm
Square Drive Size:	1/4"	3/8"	1/2"	3/4"	3/4"

Accuracy:	Better than 0.1% of reading from 10 to 100% of rated output. See calibration certificate for full results.
Signal Output:	Analogue mV
Communications:	N/A
Power and Display:	Requires a stable DC power supply and mV reading meter.
Adapter:	The IRT can be produced with shaft ends suitable to its indented function.
Speed:	Standard 20,000 RPM
Overload capability:	125%
Bridge Impedance:	350 Ω
Max Voltage and Current Requirement:	10V DC 30mA
Maximum mechanical overload:	160% of range stated.
Operating Temperature:	-10°C to +50°C.
Connector:	Mil C 26482 series. 6 pin. Shell size 10.
CE:	2014/30/EU
EMC:	BS EN 61326:2007

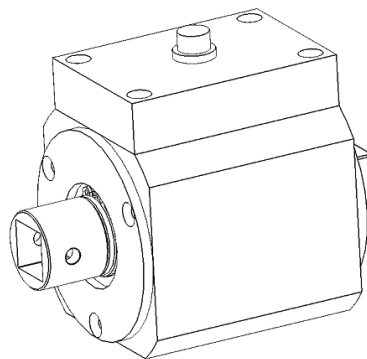

Advanced Witness Systems Ltd © 2022

MANUFACTURER INFORMATION	SUPPLIER INFORMATION
Advanced Witness Systems Ltd Unit 8 Beaumont business Centre Beaumont Close Banbury OX16 1TN Tel: +44 (0)1295 266939 Email: sales@awstorque.co.uk	