

1Nm INTELLIGENT IN-LINE TORQUE TRANSDUCER

DESCRIPTION

The AWS LTD Intelligent In-Line Torque Transducer range (IITT), is designed to accurately measure torque values, in a variety of industries.

With optimised torque ranges, the transducer contains our Intelligent Instrumentation Package, outputting using CAN-BUS protocol to communicate with the AWS LTD Professional Transducer Display (PTD). This digital communication eliminates signal loss when using long lengths of cable, providing flexibility in communicating with other devices and systems.

There is an option (using the In-line Transducer Mounting Bracket, purchased separately) to bench mount the transducer in either a vertical or horizontal position.

This transducer incorporates a mechanical overload protection stop at to prevent damage to the transducer. This transducer is either Male SQ drive to Male SQ drive or Male SQ drive to HEX drive. There are 2x M4 threaded holes in the reaction end and bottom surfaces for bolting.

A simple 2 step calibration.

Stores serial & model number, capacity, calibration coefficient, units of calibration, and conversion to other torque units.

SPECIFICATIONS

Model: IITT-	1111	1111H	1018	1018H
Ranges:	0.02-0.5Nm	0.02-0.5Nm	0.04-1Nm	0.04-1Nm
Drive Size:	¼" SQ	¼" HEX	¼" SQ	¼" HEX

Accuracy:	Better than 0.1% of reading from 10 to 100% of rated output. See calibration certificate for full results.
Modes:	Run: For Dial-type and Electronic Wrenches and Screwdrivers. Peak: For Cam-type Wrenches and Screwdrivers. 1st Peak: For Click-type Wrenches and Screwdrivers, retains reading until manually cancelled or for 3 seconds if auto cancel option is chosen.
Communication:	Canbus
Overload Capacity:	120%
Power and Display:	AWS Professional Display Model 1010 or External Power Supply 10V and canbus or PC display units with appropriate software.
Maximum mechanical overload:	150% with stop
Operating Temperature:	-10°C to +50°C.
Connector:	Mil C 26482 series. 6 pin. Shell size 10.
CE:	2014/30/EU
EMC:	BS EN 61326:2007



DIMENSIONS

Model	Dimension (mm)								
	A	B	C	D	E	F	G	H	I
IITT-1111	82	55	40	25	25	10	12	16	44
IITT-1018	82	55	40	25	25	10	12	16	44

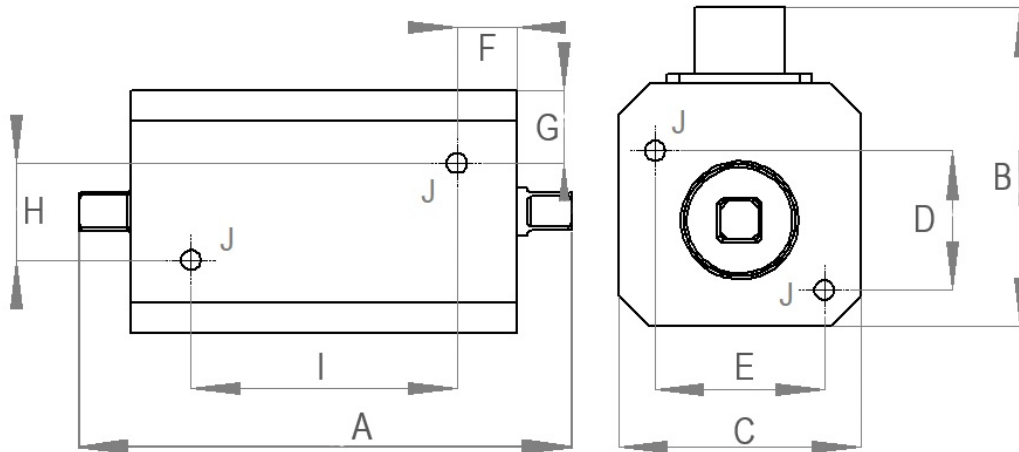
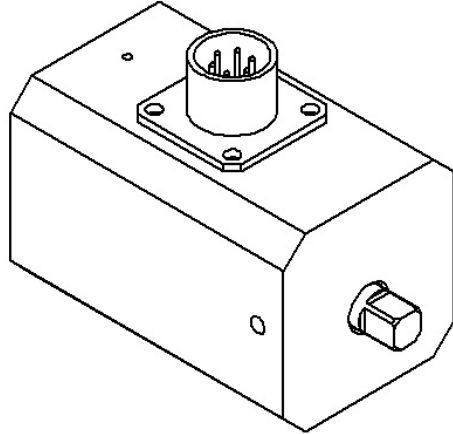

Mounting Tapped Hole "J"	Square Drive	Weight (Kg)
M4	Male 1/4"	0.3

Advanced Witness Systems Ltd © 2024

MANUFACTURER INFORMATION	SUPPLIER INFORMATION
Advanced Witness Systems Ltd Unit 8 Beaumont business Centre Beaumont Close Banbury Ox16 1TN Tel: +44 (0)1295 266939 Email: sales@awstorque.co.uk	